

PCB layout

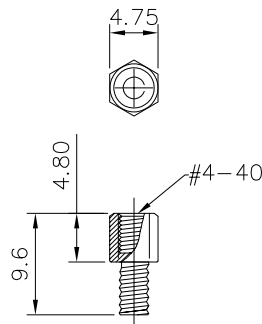

No. of Contact	2		1		
	A±0.25	B±0.13	C±0.38	D±0.50	E±0.38
15	16.30	25.00	30.80	39.60	37.10
26	24.80	33.30	39.20	48.00	45.50
44	38.30	47.04	53.04	61.60	59.10
62	54.80	63.50	69.40	78.00	75.50

Current rating: 5A
 Voltage rating: 300V
 Contact resistance: 25mΩ Max
 Dielectric withstanding voltage: 1000V AC
 Insulation resistance: 1000MΩ Min.
 Temperature range: -55°C to +125°C
 Waterproof rating: IP67
 ROHS compliant
 Part number:

BA4-0XX611XD-03

No. of contact: _____
 09: 9pin
 15: 15pin
 25: 25pin
 37: 37pin
 Terminal plating: _____
 4: Full Au 2u"
 5: Full Au 1u"

6	Glue	Glue	Color: black
5	Waterproof ring	Rubber	Color: blue
4	Screw	Steel	Plating: Ni
3	Housing	PBT+30%GF	Color: black
2	Shell	Steel	Plating: Ni
1	Terminal	Copper alloy	Plating: see part No.
Item	Desc.	Material	Remark

△				QUALITY SYMBOLS	Tolerance	NAME:	Waterproof HD.D-SUB machined pin female right angle 9.69mm(8.89)			PART NO.	BA4-0XX611XD-03		
△				□: ⊠:	.x ±0.60	REV:	A	UNIT:	mm	DRW BY	CHK BY	APP BY	DRAWING NO.
△	2025/10/09	First edition release	Carl Hu	CRITICAL MAJOR	.x ±0.40	SCALE:	N:1	DATE:	2025/10/09	Huangmei	Carl Hu		BA4-026
SIDE	DATE	DESCRIPTION	APPROVER	▽: ▽:	.xx ±0.25	东莞市林诚塑胶电子有限公司 http://www.lineconn.com TEL: 0769-85181660 85181770							
8	7	6	5	4	3	2	1						