

Current rating: 10/20/30/40 AMP.  
 Contact resistance: 2.7 milliohms max.  
 Withstanding voltage: 1000V AC  
 Insulation resistance: 5000M $\Omega$  Min.  
 Temperature range: -55 $^{\circ}$ C to +125 $^{\circ}$ C  
 ROHS compliant  
 Part number:

B08-2W2711XD-X2  
 Terminal plated: \_\_\_\_\_  
 4: Au 2 $\mu$ "  
 5: Au 1 $\mu$ "  
 Current rating: \_\_\_\_\_  
 A: 10A, Dim.A  $\phi$ 1.70, Dim.B  $\phi$ 2.20  
 B: 20A, Dim.A  $\phi$ 2.80, Dim.B  $\phi$ 3.30  
 C: 30A, Dim.A  $\phi$ 3.20, Dim.B  $\phi$ 3.70  
 D: 40A, Dim.A  $\phi$ 3.80, Dim.B  $\phi$ 4.30

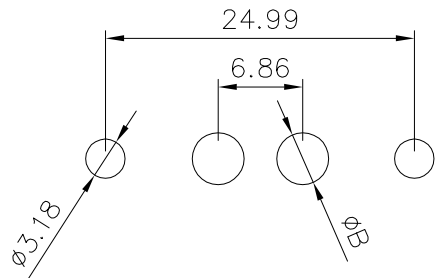

PCB layout

6	Nut	Steel	Plating: Ni
5	Housing	PBT+30%GF	Color: black
4	Riveted insert	Brass	Plating: Ni
3	Rear shell	SPCC	Plating: Sn
2	Front shell	SPCC	Plating: Ni
1	Terminal	Brass	Terminal finish: see part number
Item	Desc.	Material	Remark

				QUALITY SYMBOLS	Tolerance	NAME:	2W2 male vertical for PCB			PART NO.	B08-2W2711XD-X2		
				<input type="checkbox"/> : <input checked="" type="checkbox"/> :	x. $\pm$ 0.60	REV:	A	UNIT:	mm	DRW BY	CHK BY	APP BY	DRAWING NO.
$\triangle$	2025/08/02	First edition release	Carl Hu	CRITICAL MAJOR	.x $\pm$ 0.40	SCALE:	N:1	DATE:	2025/08/02	Huangmei	Carl Hu		B08-162
SIDE	DATE	DESCRIPTION	APPROVER	<input checked="" type="checkbox"/> : <input checked="" type="checkbox"/> :	.xx $\pm$ 0.25								
8	7	6	5	ZERO DEFECT S.P.C									

<input type="checkbox"/> : <input checked="" type="checkbox"/> :	<input checked="" type="checkbox"/> : <input checked="" type="checkbox"/> :					<b>lineconn</b> 东莞市林诚塑胶电子有限公司		http://www.lineconn.com	
						TEL:0769-85181660		85181770	