

High power terminal:  
Voltage current rating: 10~40A  
Contact resistance: 2.7mΩ max.

Signal terminal:  
Voltage current rating: 5A  
Contact resistance: 10mΩ max.

Withstanding voltage: 1000V AC  
Insulation resistance: 5000MΩ Min.  
Temperature range: -55°C to +125°C  
ROHS compliant

Part number: B08-BW4511XD-X1

Terminal plated: \_\_\_\_\_  
4: Au 2u"  
5: Au 1u"  
Current rating: \_\_\_\_\_

A: 10A, Dim.A  $\phi$ 1.70, Dim.B  $\phi$ 2.20  
B: 20A, Dim.A  $\phi$ 2.80, Dim.B  $\phi$ 3.30  
C: 30A, Dim.A  $\phi$ 3.20, Dim.B  $\phi$ 3.70  
D: 40A, Dim.A  $\phi$ 3.70 Dim.B  $\phi$ 4.20

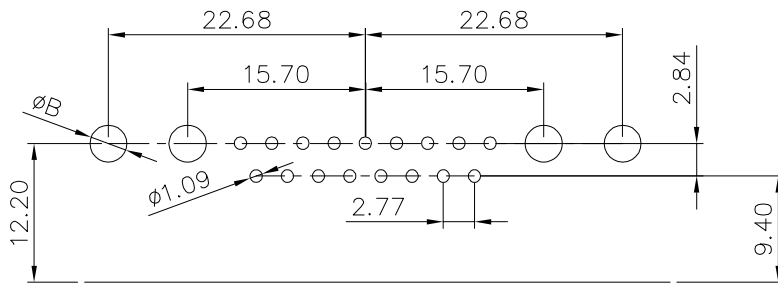
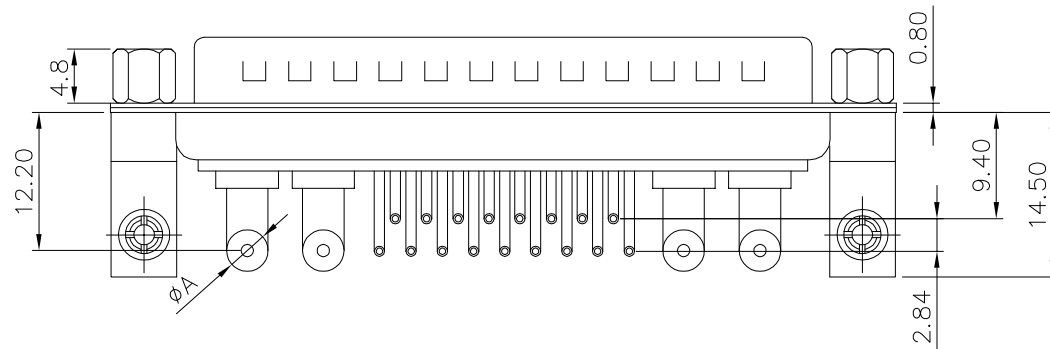

PCB layout

7	Screw	Steel	Palting: Ni
6	Board lock	Copper alloy	Palting: Sn
5	Bracket	Steel	Palting: Ni
4	Housing	PBT+30%GF	Color: black
3	Rear shell	SPCC	Palting: Sn
2	Front shell	SPCC	Palting: Ni
1	Terminal	Copper alloy	Plating: see part no.
Item	Desc.	Material	Remark

A	△	2021/06/24	Change part number	Carl Hu	QUALITY SYMBOLS <input type="checkbox"/> : <input checked="" type="checkbox"/> : CRITICAL MAJOR <input checked="" type="checkbox"/> : <input checked="" type="checkbox"/> : ZERO DEFECT S.P.C	Tolerance				NAME:	21W4 male right angle, riveted bracket, lock screw				PART NO.	B08-BW4511XD-X1		
	△	2020/01/14	Add dimension annotations	Jack Chen		.x	±0.60	REV:	C	UNIT:	mm	DRW BY	CHK BY	APP BY	DRAWING NO.			
	△	2019/06/21	First edition release	Jack Chen		.x	±0.40	SCALE:	N:1	DATE:	2019/06/21	Yugong	Carl Hu		B08-075			
	SIDE	DATE	DESCRIPTION	APPROVER		.xx	±0.25	东莞市林诚塑胶电子有限公司				<a href="http://www.lineconn.com">http://www.lineconn.com</a> TEL: 0769-85181660 85181770						