

High power terminal:
Voltage current rating: 10~40A
Contact resistance: 2.7mΩ max.

Signal terminal:
Voltage current rating: 5A
Contact resistance: 10mΩ max.

Withstanding voltage: 1000V AC
Insulation resistance: 5000MΩ Min.
Temperature range: -55°C to +125°C
ROHS compliant

Part number:
B08-AW2511XD-X1

Terminal plated: _____

4: Au 2u"

5: Au 1u"

Current rating: _____

A: 10A, Dim. A $\phi 1.70$, Dim. B $\phi 2.20$

B: 20A, Dim. A $\phi 2.80$, Dim. B $\phi 3.30$

C: 30A, Dim. A $\phi 3.20$, Dim. B $\phi 3.70$

D: 40A, Dim. A $\phi 3.70$ Dim. B $\phi 4.20$

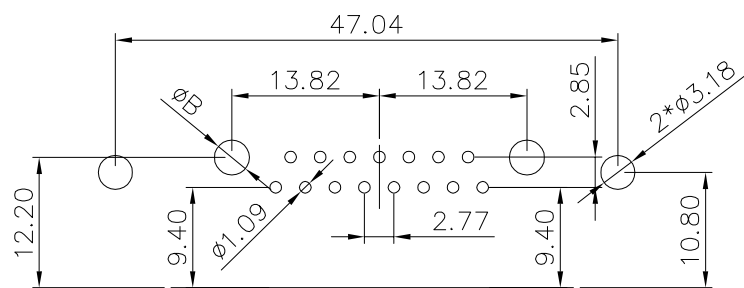
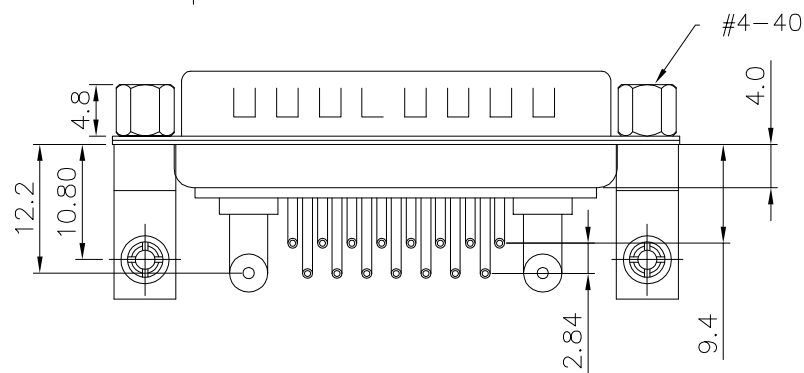

PCB layout

7	Screw	Steel	Palting: Ni
6	Board lock	Copper alloy	Palting: Sn
5	Bracket	Steel	Palting: Ni
4	Housing	PBT+30%GF	Color: black
3	Rear shell	SPCC	Palting: Sn
2	Front shell	SPCC	Palting: Ni
1	Terminal	Copper alloy	Plating: see part no.
Item	Desc.	Material	Remark

A	△	2021/06/24	Change part number	Carl Hu	QUALITY SYMBOLS □: ☒: CRITICAL MAJOR ▽: ▽: ZERO DEFECT S.P.C	Tolerance .x ±0.60 .x ±0.40 .xx ±0.25	NAME:	17W2 male right angle, riveted bracket, lock screw			PART NO.	B08-AW2511XD-X1		
	△	2019/03/11	Add dimension annotations	Jing Li			REV:	C	UNIT:	mm	DRW BY	CHK BY	APP BY	DRAWING NO. B08-047
	△	2017/05/13	First edition release	Jing Li			SCALE:	N:1	DATE:	2017/05/13	Yugong	Carl Hu		
	SIDE	DATE	DESCRIPTION				APPROVER	东莞市林诚塑胶电子有限公司 http://www.lineconn.com TEL: 0769-85181660 85181770						