

Entry Hold OD 10.0mm

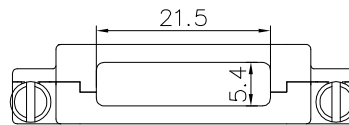

Entry Hold 4C

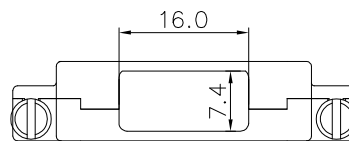

Entry Hold 8C

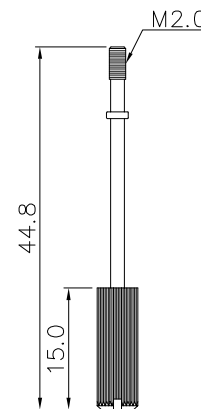

Current rating: 1A
 Voltage rating: 30V AC(rms)
 Withstanding voltage: 250V AC
 Contact resistance : 50mΩ max.
 Insulation resistance: 500MΩ Min.
 Temperature range: -45°C to +105°C
 ROHS compliant

Part number:
 B06-068G11EJ-XX

Entry hole size:
 01: OD 10.0mm
 4C: 21.5*5.4mm
 8C: 16.0*7.4mm

Item	Desc.	Material	Remark
6	Screw	Steel	Plating: Ni
5	Cable clip	Steel	Plating: Ni
4	Hood	Zinc alloy	Plating: Ni
3	Housing	PBT+G.F.30%	Color: black
2	Sheel	SPCC	Plating: Ni
1	Terminal	Phosphor bronze	Contact area: Au 5u" Solder area: Sn Under-plating: Ni

△	2021/06/30	Changed part number	Carl Hu
△	2019/03/14	Changed tolerance	Jing Li
△	2019/03/03	First edition release	Jing Li

QUALITY SYMBOLS	
□:	☒:
CRITICAL	MAJOR
▽:	▽:
ZERO DEFECT	S.P.C

Tolerance	
.x	±0.80
.x	±0.50
.xx	±0.25

NAME:	VHDCI(pitch 0.8mm) 68pin male clip,zinc alloy hood screw type			PART NO.	B06-068G11EJ-XX		
REV:	C	UNIT:	mm	DRW BY	CHK BY	APP BY	DRAWING NO.
SCALE:	N:1	DATE:	2019/03/03	Yugong	Carl Hu		B06-026

SIDE	DATE	DESCRIPTION	APPROVER
8	7	6	5

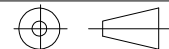

Lineconn 东莞市林诚塑胶电子有限公司 <http://www.lineconn.com>
 TEL: 0769-85181660 85181770