

Pin No.	A	B	C±0.38
09	16.33	24.99	30.81
15	24.66	33.32	39.14
25	38.38	47.04	53.04
37	54.84	63.50	69.32

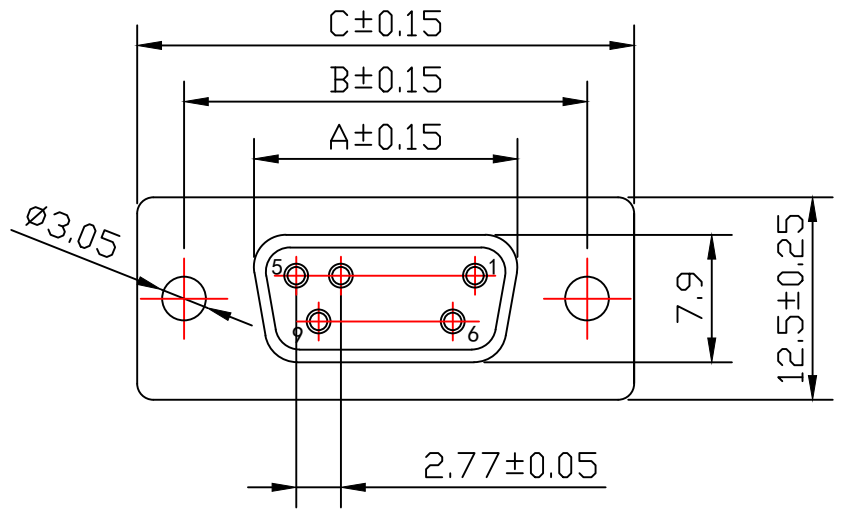
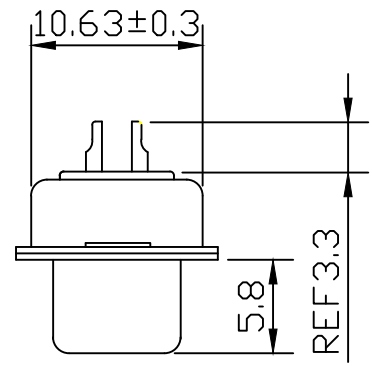
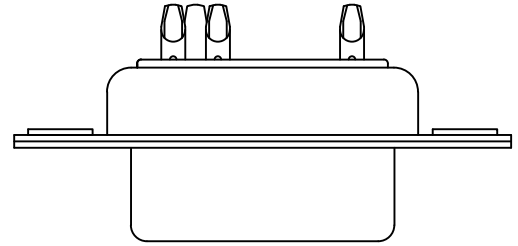

Voltage current rating: 5 AMP.
 Dielectric withstanding voltage: 1000V AC
 Insulation resistance: 1000MΩ min.
 Temperature range: -55℃ to +105℃

Part No.: B05-0XX4X1XN-02
 Pin No.: _____
 09: 9pin
 15: 15pin
 25: 25pin
 37: 37pin
 Housing color: _____
 1: Black
 5: White
 6: Blue
 Terminal plating: _____
 4: Full Au 2u"
 5: Full Au 1u"

4	REAR SHELL	SPCC	PLATING: Sn
3	FRONT SHELL	SPCC	PLATING: Ni
2	HOUSING	PBT+30%GF	COLOR: SEE PART NO.
1	TERMINAL	COPPER ALLOY	PLATING: SEE PART NO.
ITEM	DESC.	MATERIAL	REMARKS

△	2022/03/27	Modified operating temperature	Jack Chen
△	2022/03/26	Added specifications for terminal plating	Jack Chen
△	2009/04/14	NEW ISSUE	JINGLI
SIDE	DATE	DESCRIPTION	APPROVER
8	7	6	5

QUALITY SYMBOLS		Tolerance	
□:	☒:	.x	±0.60
CRITICAL	MAJOR	.x	±0.40
▽:	▽:	.xx	±0.25
ZERO DEFECT	S.P.C		

NAME:		D-SUB 车针母头焊线式通孔			PART NO.		B05-0XX4X1XN-02		
REV:	C	UNIT:	mm	DRW BY	CHK BY	APP BY	DRAWING NO.		
SCALE:	N:1	DATE:	2009/04/14	Huangmei	Jack Chen	B05-015			
				东莞市林诚塑胶电子有限公司				http://www.lineconn.com TEL: 0769-85181660 85181770	
8	7	6	5	4	3	2	1		