

Voltage Current Rating:3 AMP.  
 Dielectric Withstanding Voltage:500V AC  
 Insulation Resistance:500MΩ Min.  
 Temperature Range:-40°C to +125°C

PART NO:  
 B05-0234X1AN-01

HOUSING COLOR:   
 1 = BLACK  
 5 = WHITE  
 6 = BLUE

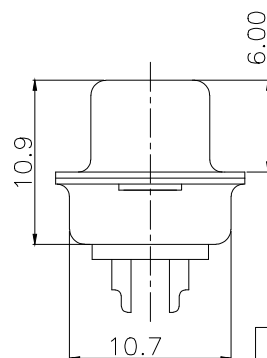
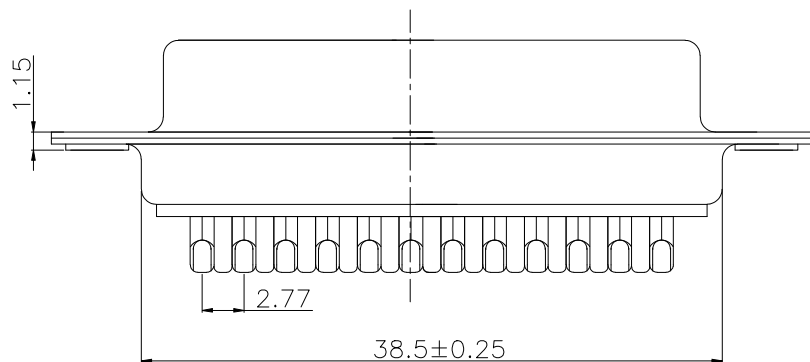

4	REAR SHELL	SPCC	PALTING: Sn	
3	FRONT SHELL	SPCC	PALTING: Ni	
2	HOUSING	PBT+30%GF	COLOR: SEE PART NO.	
1	TERMINAL	COPPER ALLOY	CONTACT AREA: G/F	
			SOLDER AREA: Sn	
ITEM	DESC.	MATERIAL	REMARKS	PART REMARKS

△	2022/04/16	NEW ISSUE	Jack Chen	
SIDE	DATE	DESCRIPTION	APPROVER	
8	7	6	5	4

QUALITY SYMBOLS  
 □: CRITICAL  
 ▽: ZERO DEFECT  
 ☒: MAJOR  
 ▽: S.P.C

Tolerance  
 x. ±0.50  
 .x ±0.30  
 .xx ±0.25

NAME:	D-SUB 23Pin Female Connector Solder Type				PART NO.	B05-0234X1AN-01		
REV:	A	UNIT:	mm	DRW BY	CHK BY	APP BY	DRAWING NO.	
SCALE:	N:1	DATE:	2022/04/16	Huangmei	Jack Chen		B05-182	
东莞市林诚塑胶电子有限公司				<a href="http://www.lineconn.com">http://www.lineconn.com</a> TEL:0769-85181660 85181770				

Lineconn 东莞市林诚塑胶电子有限公司  
<http://www.lineconn.com>  
 TEL:0769-85181660 85181770