

Voltage Current Rating:5 AMP.  
 Dielectric Withstanding Voltage:1000V AC  
 Insulation Resistance:1000MΩ Min.  
 Temperature Range:-25°C to +85°C

PART NO:  
 B05-0504X14N-02

HOUSING COLOR:  
 1 = BLACK  
 5 = WHITE  
 6 = BLUE

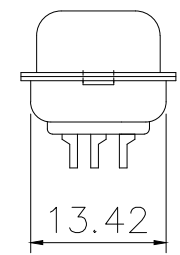
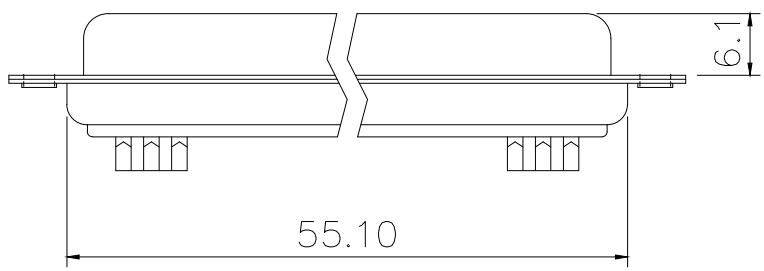

4	REAR SHELL	SPCC	PALTING: Sn	
3	FRONT SHELL	SPCC	PALTING: Ni	
2	HOUSING	PBT+30%GF	COLOR: SEE PART NO.	
1	TERMINAL	COPPER ALLOY	TERMINAL FINISH: FULL GOLD FINISHED 2u"	
ITEM	DESC.	MATERIAL	REMAKS	PART REMAKS

				QUALITY SYMBOLS	Tolerance	NAME: D-SUB 50P母头车针焊线式 (客户用图)	PART NO. B05-0504X14N-02
				□: CRITICAL	x. ±0.50	REV: A	CHK BY
				☒: MAJOR	.x ±0.30	UNIT: mm	APP BY
				▽: ZERO DEFECT	.xx ±0.25	SCALE: N:1	DRAWING NO. B05-019
				▽: S.P.C		DATE: 2010/06/03	
SIDE	DATE	DESCRIPTION	APPROVER			DRW BY: JINGLI	
8	7	6	5			DRW BY: KING ZHOU	

东莞市林诚塑胶电子有限公司  
<http://www.lineconn.com>  
 TEL: 0769-85181660 85181770