

Entry Hole

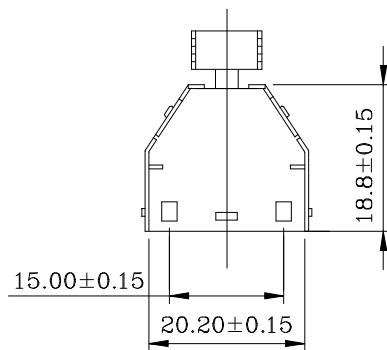
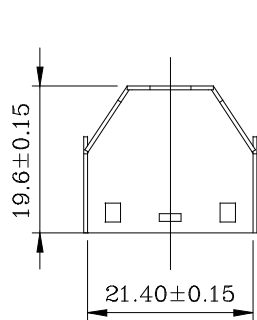
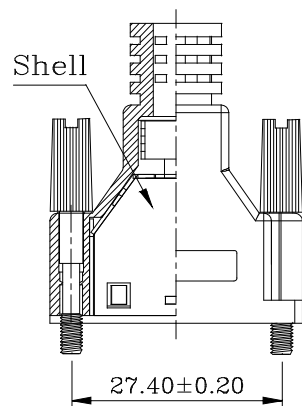
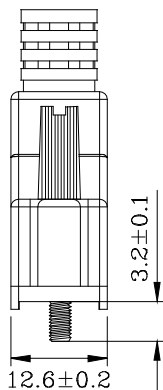
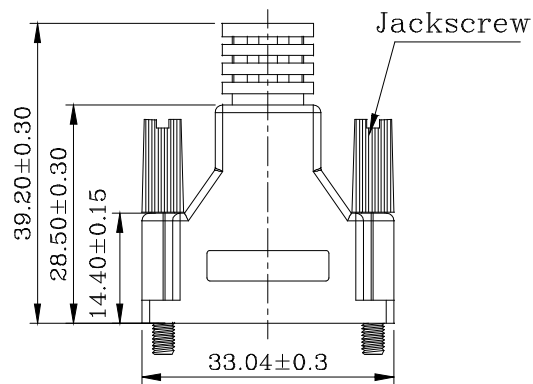
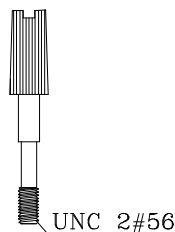
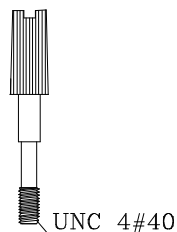
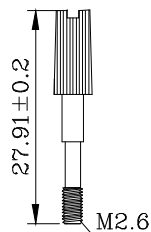

• PART NO.:

B03-020N11NX-X1

THREADS FINISHES:

7: jackscrews M2.6

8: jackscrews #2-56

9: jackscrews #4-40

ENTRY HOLE SIZES:

6:6.0

7:7.0

4	INNER SHELL	STEEL	PLATING: Ni	
3	SCREWS	STEEL	PLATING: Ni	
2	SCREWS HOOD	PVC(30P)	COLOR: BLACK	
1	HOOD	ABS UL94V-0	COLOR: BLACK	
ITEM	DESC.	MATERIAL	REMAKS	PART REMAKS

△				QUALITY SYMBOLS
△				□: ⊠: x: ±0.80
△	2009/06/05新版发行		King Zhou	CRITICAL MAJOR .x ±0.50
SIDE	DATE	DESCRIPTION	APPROVER	▽: ▽: .xx ±0.30
8	7	6	5	ZERO DEFECT S.P.C

Tolerance		NAME:	SCSI 20P MALE 塑胶组装外壳 螺丝式 (客户用图)			PART NO.	B03-020N11NX-X1		
x	±0.80	REV:	A	UNIT:	mm	DRW BY	CHK BY	APP BY	DRAWING NO.
.x	±0.50	SCALE:	N:1	DATE:	2009/06/05	JACK CHEN	DEAN FAN		B03-051
.xx	±0.30	Lineconn 东莞市林诚塑胶电子有限公司			http://www.lineconn.com		TEL:0769-85181660 85181770		

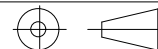

Lineconn 东莞市林诚塑胶电子有限公司 http://www.lineconn.com TEL:0769-85181660 85181770