

High Power Contact Current Rating:  
10,20 or 40AMPS  
High Power Contact Resistance:  
2.7 Milliohms Max.  
Dielectric Withstanding Voltage:  
1000V AC For 1 Minute  
Insulation Resistance:5000MΩ Min.  
Temperature Range:-25°C to +85°C

PART NO:  
B08-AW55X14D-X1

HOUSING COLOR:  
1:BLACK  
3:GREEN  
5:WHITE

CURRENT RATING:  
A = 10 AMPS Dim.A  $\phi$ 1.7 Dim.B  $\phi$ 2.2  
B = 20 AMPS Dim.A  $\phi$ 2.8 Dim.B  $\phi$ 3.3  
C = 30 AMPS Dim.A  $\phi$ 3.2 Dim.B  $\phi$ 3.7  
D = 40 AMPS Dim.A  $\phi$ 3.7 Dim.B  $\phi$ 4.2

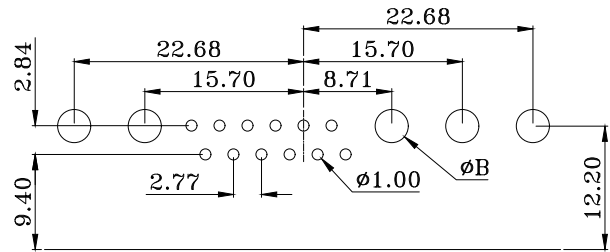
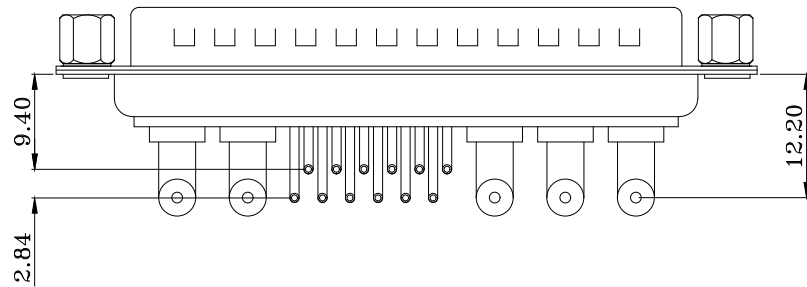

PCB LAYOUT

6	JACKSCREWS	BRASS	PLATING:Ni	
5	HOUSING	PBT+30%GF	COLOR: WHITE	
4	RIVETED INSERT	BRASS	PLATING:Ni	
3	REAR SHELL	SPCC	PLATING:Sn	
2	FRONT SHELL	SPCC	PLATING:Ni	
1	TERMINAL	BRASS	TERMINAL FINISH: FULL GOLD FINISHED 2u"	
ITEM	DESC.	MATERIAL	REMAKS	PART REMAKS

QUALITY SYMBOLS

□:    ☒:  
CRITICAL MAJOR  
▽:    ▽:  
ZERO DEFECTS.P.C

Tolerance

.x    ±0.50  
.x    ±0.30  
.xx   ±0.25

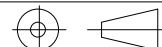

NAME:	17W5 90度公头铆支架鱼叉锁螺丝 POWER D-SUB (客户用图)				PART NO.	B08-AW55114D-X1		
REV:	A	UNIT:	mm	DRW BY	CHK BY	APP BY	DRAWING NO.	
SCALE:	N:1	DATE:	2018/09/22	JINGLI	KING ZHOU		B08-049	

Lineconn 东莞市林诚塑胶电子有限公司 <http://www.lineconn.com>  
TEL: 0769-85181660 85181770

△	2018/09/22	NEW ISSUE	JINGLI
SIDE	DATE	DESCRIPTION	APPROVER